



EMERGENCY REPAIR NOTICE

241 Repair Project, Lane Shift and Restriping Work

Nighttime Closures

Northbound and Southbound 241 Toll Road between 133 and 261

Beginning March 31, 2025, the California Department of Transportation (Caltrans) will conduct emergency roadway work on the northbound and southbound 241 Toll Road between the 133 Toll Road and 261 Toll Road as part of the 241 Emergency Repair Project. Required nightly closures will occur Monday, March 31 through Thursday, April 3. As part of the work, a lane shift, restriping and lane reductions will take place allowing crews a safe work zone to reconstruct a failed slope and repair the roadway. Please look for detour signage in the closure area.

When

Nightly, Monday, March 31 – Thursday, April 3

- **Southbound 241 Toll Road:**
Monday, March 31 and Tuesday, April 1, 9 p.m. to 5 a.m.
- **Northbound SR 241:**
Wednesday, April 2 and Thursday, April 3, 9 p.m. to 5 a.m.

What to Expect

- Nightly directional closures northbound and southbound, 241 Toll Road
- Extended lane shift and reduction of lanes in work zone through October 2025
- Signage in place to assist motorists with detours

Detour for Southbound 241 Toll Road Motorists

During southbound 241 Toll Road closures, motorists will be directed to southbound 261 Toll Road at the 241/261 interchange, exit at Portola Pkwy. and proceed left on Portola to reenter southbound 241. Detours may require additional tolls.

Detour for Northbound 241 Toll Road Motorists

During the nightly northbound 241 Toll Road closures, drivers will be directed to exit at Portola Parkway (north) and proceed to re-enter northbound 261 Toll Road. Northbound 133 Toll Road drivers will be directed to exit at Irvine Boulevard and to follow detour signage. Detours may require additional tolls.

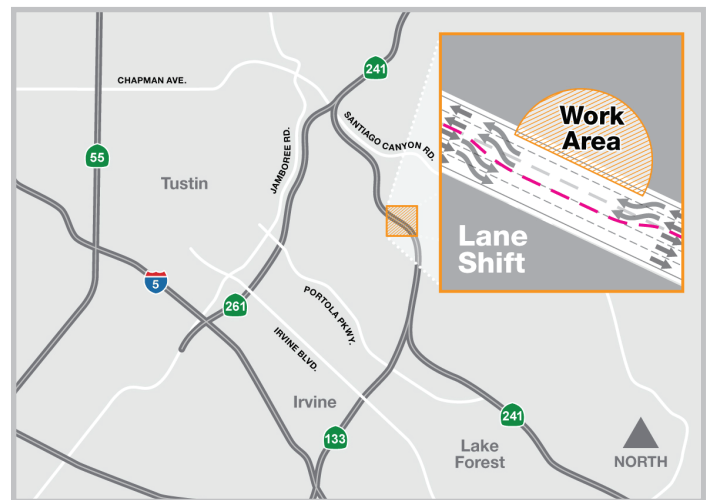
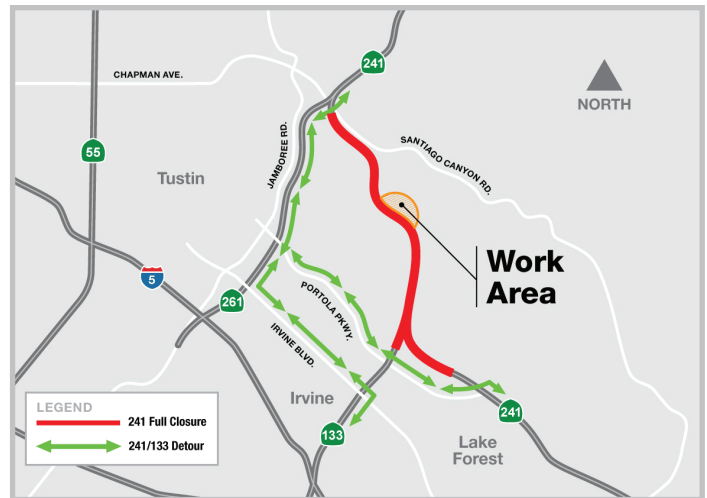

Schedule is subject to change due to inclement weather or unforeseen circumstances. For up-to-date closure information and dates, visit the Caltrans Quickmap at quickmap.dot.ca.gov

For additional information, visit TheTollRoads.com | [@TheTollRoads](https://twitter.com/TheTollRoads)

